

## Chicago River

*The Chicago River is 251 km long and used to flow through downtown Chicago to Lake Michigan. The flow was engineered to go south in the nineteenth century. Local custom is to dye the river green on St. Patrick's Day.*



## Publication

A collection of the keynotes, papers and documented software demonstrations is published as a special issue of the "International Regional Science Review". Submissions are due by September 1, 2010. The issue will be published in 2011.

## Thanks to:



### Purdue University

Department of Agricultural Economics  
Space, Health and Population Economics Program (SHaPE)  
403 W. State Street  
West Lafayette, IN 47907

<http://www.agecon.purdue.edu/shape/>, [shape@purdue.edu](mailto:shape@purdue.edu)  
[http://www.agecon.purdue.edu/sea\\_2010/](http://www.agecon.purdue.edu/sea_2010/), [sea2010@purdue.edu](mailto:sea2010@purdue.edu)



Purdue University presents the

## IVth World Conference of the Spatial Econometrics Association

Chicago, June 9–12, 2010



# Welcome

## Welcome from the Chair

Location matters! With the shores of Lake Michigan, the “Magnificent Mile”, Millennium Park and Navy Pier in walking distance from our conference venue, you should have a wonderful experience in Chicago. I am delighted to welcome you to Chicago to participate in the IVth World Conference of the Spatial Econometrics Association.

The scientific program features many distinguished speakers and this year – for the first time – we will also have a panel discussion on teaching spatial econometrics and a software demonstration session. A selection of the papers presented at the conference will be published as a special issue of the “International Regional Science Review”.

The conference has been generously sponsored by the Department of Agricultural Economics of Purdue University, the Wickersham Chair of Excellence in Agricultural Research, the Department of Spatial Economics at the VU University Amsterdam, and the Spatial Econometrics Association.

Many of the members of the Local Organizing Committee are graduate students in the Space, Health and Population Economics (SHaPE) program at Purdue University. They will be happy to assist you with any request or query that you may have.

Raymond J.G.M. Florax  
Chair Local Organizing Committee  
[http://www.agecon.purdue.edu/sea\\_2010/](http://www.agecon.purdue.edu/sea_2010/)

# Committees

## Local Organizing Committee

The members of the Local Organizing Committee are faculty, staff and graduate students from the Department of Agricultural Economics, the Department of Economics and the Conference Division of Purdue University.

Yong Bao	David L. Ortega
Benoît A. Delbecq	Marsha Pritchard
Elizabeth A. Dobis	Brigitte S. Waldorf
Raymond J.G.M. Florax (chair)	Patrick S. Ward
C. Gustav Helmers	Susan R. Xioufaridou

## Scientific Advisory Board

Luc Anselin, Arizona State University  
Giuseppe Arbia, D’Annunzio University  
Anil K. Bera, University of Illinois  
Badi H. Baltagi, Syracuse University  
Roger S. Bivand, Norwegian School of Economics and Business Administration  
Bernard Fingleton, Strathclyde University  
Raymond J.G.M. Florax, Purdue University  
Alfonso Flores-Lagunes, University of Florida

## Lake Michigan

*The conference hotel is at walking distance from the shores of Lake Michigan.*



# Committees

## Scientific Advisory Board, continued

Elena G. Irwin, Ohio State University  
Dayton M. Lambert, University of Tennessee  
Julie Le Gallo, Université de Franche-Comté  
James P. LeSage, Texas State University at San Marcos  
Enrique López-Bazo, University of Barcelona  
Daniel P. McMillen, University of Illinois  
Michael Pfaffermayr, University of Innsbruck  
Ingmar R. Prucha, University of Maryland

## Jury for Graduate Student Competition

The Spatial Econometrics Association sponsors a graduate student paper competition with a first prize of \$300 and a second prize of \$200. The jury comprises:

Giuseppe Arbia, D'Annunzio University  
Anil K. Bera, University of Illinois  
Eckhardt Bode, Kiel Institute for the World Economy  
Timothy G. Conley, University of Chicago  
Jesus Mur, University of Zaragoza  
Guido Pellegrini, University of Rome

The prizewinners will be announced during the conference dinner on Friday.

# SEA

## Spatial Econometrics Association (SEA)

The SEA organized previous conferences in Rome (Italy, 2006, founding conference), Cambridge (England, 2007), New York (USA, 2008), and Barcelona (Spain, 2009).

## SEA Board of Directors

Luc Anselin	Jean Paelinck
Giuseppe Arbia (chair)	Ingmar Prucha
Badi Baltagi	Peter Robinson
Harry Kelejian	

## SEA Fellows

Luc Anselin	Lung-Fei Lee
Giuseppe Arbia	James LeSage
Badi Baltagi	Jesus Mur
Anil Bera	Hashem Pesaran
Noel Cressie	Jean Paelinck
Bernard Fingleton	Ingmar Prucha
Raymond Florax	Danny Quah
Daniel Griffith	Serge Rey
Robert Haining	Peter Robinson
Harry Kelejian	Dag Tjostheim



# Guidelines

## AV Equipment and Laptop

Each room is equipped with an LCD projector (beamer). The chair of the session is responsible for providing a laptop computer, and may want to coordinate the availability of a laptop with the presenters. Generally it is sufficient if the laptop provides access to PowerPoint and Adobe Acrobat Reader. Please bring your presentation file on a USB memory stick and upload your file before the session starts.

## Session Organization

All presenters should arrive 10 minutes in advance and make sure that no technical problems occur. Each presenter has 20-30 minutes to present, 5 minutes for his or her discussants' presentation and 5 minutes for general discussion. Please respect the time limit for presenting your paper and for the discussion. The chairs are advised to enforce the time constraints.

## Session Chair

Session chairs have been assigned in the program. The chair has to ensure that a laptop is available and that time constraints are met. He or she should welcome and introduce the participants and moderate the open discussion. If the session's chair is absent, the last presenter listed should take the role of the chair.

## Discussant

Every presenter is discussant of the previous paper as indicated in the program. Accordingly, the second speaker is discussant of the first paper; the third speaker is discussant of the second paper, and so forth. The first speaker is discussant of the last paper.

# The City of Chicago

## Skyline and Millennium Park

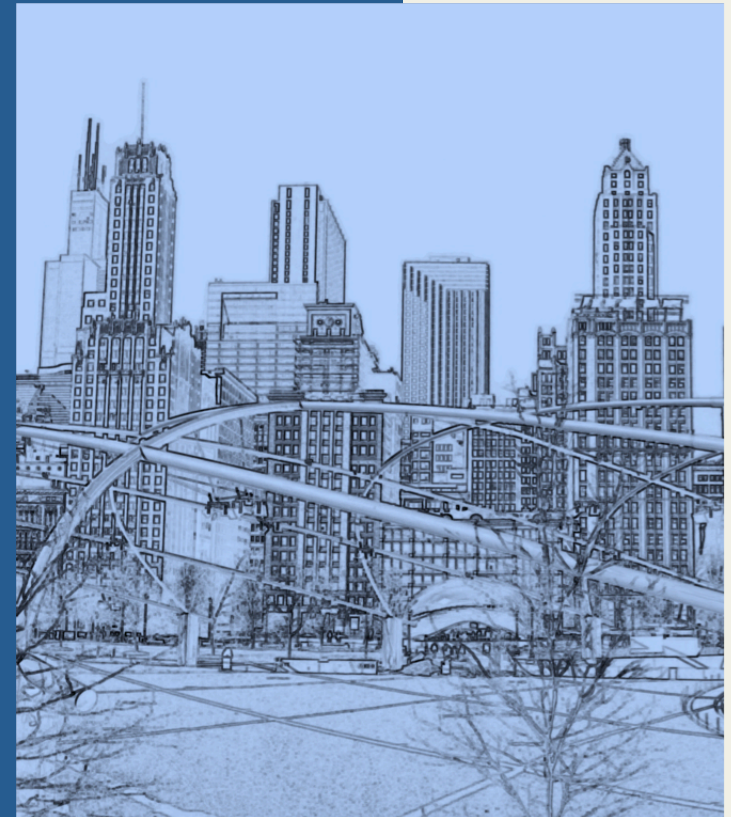

# Program at a Glance

Timeslot	Wednesday 9-Jun	Thursday 10-Jun	Friday 11-Jun	Saturday 12-Jun
8:30 - 9:00	Registration	Plenary	Plenary	Teaching panel
9:00 - 9:30				Coffee break
9:30 - 10:00				
10:00 - 10:30		Coffee break		
10:30 - 11:00			Session 4.1-4.3	Software demo
11:00 - 11:30		Session 1.1-1.4		
11:30 - 12:00				
12:00 - 12:30		Lunch break	Lunch break	Lunch break
12:30 - 1:00				
1:00 - 1:30				
1:30 - 2:00				
2:00 - 2:30		Session 2.1-2.4	Session 5.1-5.4	
2:30 - 3:00				
3:00 - 3:30				
3:30 - 4:00	Coffee break	Coffee break		
4:00 - 4:30				
4:30 - 5:00	Session 3.1-3.4	Session 6.1-6.4		
5:00 - 5:30				
5:30 - 6:00				
6:00 - 6:30				
6:30 - 7:00				
7:00 - 7:30	Reception			
7:30 - 8:00			Dinner	
8:00 - 8:30				
8:30 - 9:00				

# Program, Wednesday PM

## Registration

The registration desk is located in the Ontario Foyer (Pre-function Area) on the lower level (LL) in front of the Ontario Ballroom.

5:00 – 7:30 pm Registration

## Opening Reception

The opening reception takes place in Ontario Ballroom B on the lower level of the hotel.

7:00 – 9:00 pm Reception

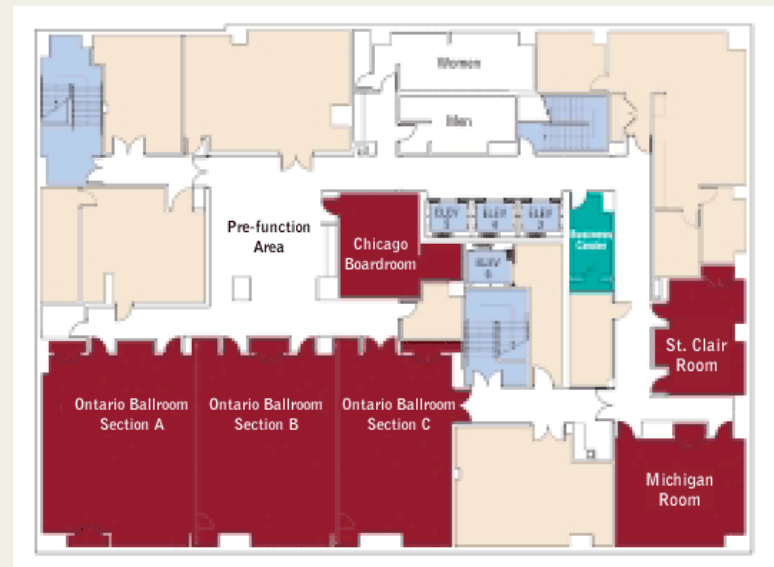

# Program, Thursday AM

## Registration

The registration desk will be open all day, starting from half an hour before the program commences. Feel free to approach the local organizers with all your questions and queries.

8:00 am – 6:00 pm      Registration

## Plenary session, 8:30 – 10:00 am, Ontario Ballroom

### *Welcome*

Raymond J.G.M. Florax, Chair Local Organizing Committee

### *Spatial Analysis: From Times of Cholera to Crimes in Columbus.*

Keynote speech Anil K. Bera, University of Illinois, USA

### *Spatial Econometrics Association Members Assembly*

Giuseppe Arbia, Chairman SEA

## Coffee Break, 10:00 – 10:30 am, Ontario Foyer

# Program, Thursday AM

## Session 1.1, 10:30 am – 12:00 pm, Ontario A Spatial Econometric Theory I

Chair: Yong Bao, Purdue University, USA

*On Specification and Identification in Spatial Econometric Models.* Jean Paelinck, D. Das Gupta, and U.P. Kelekar, George Mason University, USA.

*Fixed-b Asymptotics for Spatially Dependent Robust Nonparametric Covariance Matrix Estimators.* C. Alan Bester, Timothy G. Conley, Christian B. Hansen, University of Chicago Booth School of Business, USA, and Timothy J. Vogelsang, Michigan State University, USA.

*Spatial Effects in SUR Models: Specification and Testing.* Ana Angulo, University of Zaragoza, Spain, Fernando López, Technical University of Cartagena, Spain, and Jesus Mur, University of Zaragoza, Spain.

## Session 1.2, 10:30 am – 12:00 pm, Ontario B Agglomeration and Spatial Effects

Chair: Matthias Firgo, Wirtschaftsuniversität Wien, Austria

*Weighting Ripley's K-function to Account for the Firm Dimension in the Analysis of Spatial Concentration.* Giuseppe Arbia, University of Pescara, Italy, Giuseppe Espa and Diego Giuliani, University of Trento, Italy.

*Modelling the Folk Theorem of Spatial Economics: A Heterogeneous Regional Growth Model.* Torben Klarl, University of Augsburg, Germany.

*The Mysteries of the Trade: Interindustry Spillovers in Cities.* Wolfgang Dauth, Institute for Employment Research (IAB) Nürnberg, Germany.

# Program, Thursday AM

## **Session 1.3, 10:30 am – 12:00 pm, Ontario C Infrastructure and Technology**

Chair: Fernando DePaolis, Monterey Institute of International Studies, USA

*Agricultural Productivity and Anticipated Climate Change in Sub-Saharan Africa: A Spatial Sample Selection Model.* Patrick Ward, Raymond J.G.M. Florax, Purdue University, USA, and Alfonso Flores-Lagunes, University of Florida, USA.

*Spatial Complementarity of FDI: Example of Transition Countries.* Oleksandr Shepotylo, Kyiv School of Economics, Ukraine.

## **Session 1.4, 10:30 am – 12:00 pm, Michigan Spatial Structure**

Chair: Nicolas Debarsy, University of Namur, Belgium

*A New Areal Interpolation Technique Based on Spatial Econometrics.* Daisuke Murakami and Morito Tsutsumi, University of Tsukuba, Japan.

*Improbable Nature of the Implied Correlation Matrix from Spatial Regression Models.* Monalisa Sen and Anil K. Bera, University of Illinois, USA.

*Social Networks and the Spatial Diffusion of Subprime Mortgages.* Rubén Hernández-Murillo and Rajdeep Sengupta, Federal Reserve Bank of St. Louis, USA.

## **Lunch Break, 12:00 – 1:30 pm**

Meeting Jury Graduate Student Paper Competition, St. Clair Boardroom, by invitation only

# Program, Thursday PM

## **Session 2.1, 1:30 – 3:30 pm, Ontario A Spatial Econometric Theory II**

Chair: Olivier Parent, University of Cincinnati, USA

*Pseudo GLS Regression Estimation with Spatial Data.* Cuicui Lu, Michigan State University, USA.

*Bias-Corrected Estimation for Spatial Autocorrelation.* Zhenlin Yang, Singapore Management University, Singapore.

*On 2nd-order Hidden Heterogeneity in Spatial Econometric Models.* Giuseppe Arbia, University of Pescara, Italy, Anil Bera, University of Illinois, USA, and Gianfranco Piras, Cornell University, USA.

*Finite Sample Bias of QMLE in Spatial Autoregressive Models.* Yong Bao, Purdue University, USA.

## **Session 2.2, 1:30 – 3:30 pm, Ontario B Urban Analysis I**

Chair: Daniel P. McMillen, University of Illinois, USA

*When all Miles Are not the Same: Spatial Non-Stationary Impacts of Educational Travel Time Requirements.* Jeremy L. Sage, Washington State University, USA.

*Economic Performance and Quality of Life in European Cities.* Maksim Belitski, University of Leicester, UK, Francesco Moscone, Brunel University, UK, and Elisa Tosetti, Cambridge University, UK.

*Modeling Interdependencies between Vehicle Transaction, Residential Relocation and Job Change.* Taha Rashidi, Abolfazi Mohammadian, University of Illinois at Chicago, USA, and Frank S. Koppelman, Northwestern University, USA.

## Program, Thursday PM

### **Session 2.3, 1:30 – 3:30 pm, Ontario C Economic Growth I**

Chair: Wolfgang Dauth, Institute for Employment Research (IAB)  
Nürnberg, Germany

*Convergence Analysis as Distribution Dynamics when Data Are Spatially Dependent.* Margherita Gerolimetto and Stefano Magrini, Ca'Foscari University of Venice, Italy.

*Is Agricultural Production Spillover the Rationale Behind CAADP Framework? Spatial Panel Model Approach.* John Musua Ulimwengu, International Food Policy Research Institute, USA, and Prabuddha Sanyal, Odenton, USA.

*Oil Prices and Economic Growth in South Africa: An ARDL-Bounds Testing Approach.* Nicholas M. Odhiambo, University of South Africa, South Africa.

### **Session 2.4, 1:30 – 3:30 pm, Michigan Labor Markets and Schooling**

Chair: Trevor Kollmann, University of Arizona, USA

*Forecasting Regional Labor Markets with GVAR Models and Indicators.* Norbert Schanne, Institute for Employment Research (IAB), Germany.

*Dynamics of Spatial Inequality in the Brazilian Labor Market between 1980 and 2000: A Fixed Effect Approach.* Alexandre Gori-Maia, University of Campinas, Brazil.

*Understanding the Effects of School Competition and Gentrification on School Performance: An application of the Spatial STAR Model.* Samantha Snyder, Raymond J.G.M. Florax, Purdue University, USA, and Daniel P. McMillen, University of Illinois, USA.

## Program, Thursday PM

### **Coffee Break, 3:30 – 4:00 pm, Ontario Foyer**

### **Session 3.1, 4:30 – 6:00 pm, Ontario A Bayesian Spatial Econometrics**

Chair: Cuicui Lu, Michigan State University, USA

*Spatial Dynamic Panel Data Models with Random Effects.* Olivier Parent, University of Cincinnati, USA, and James P. LeSage, Texas State University at San Marcos, USA.

*Spatial Hierarchical Bayesian Model for Missing Data Imputation.* Hajime Seya, National Institute for Environmental Studies, Japan, and Morito Tsutsumi, University of Tsukuba, Japan.

*Bayesian Estimation of the Spatial Durbin Error Model with an Application on Voter Turnout in the 2004 Election.* Donald J. Lacombe, West Virginia University, USA, Garth J. Holloway, University of Reading, UK, and Timothy M. Shaughnessy, Louisiana State University at Shreveport, USA.

*A Simultaneous Equations Model of Fiscal Policy Interactions.* Maarten A. Allers and J. Paul Elhorst, University of Groningen, The Netherlands.

## Program, Thursday PM

### **Session 3.2, 4:30 – 6:00 pm, Ontario B Industries and Amenities**

Chair: Torben Klarl, University of Augsburg, Germany

*A Generalized Cross-Entropy Approach to Analyze the Structural and Spatial Change in the French Dairy Farms.* Nejla Ben Arfa, Karine Daniel, Laress-ESA Angers, France, and Florence Jacquet, INRA, France.

*Testing for Spatial Location Patterns of Bogotá's Small and Medium Size Manufacturing Firms, 2006-2008.* Hernán Enríquez and Juan Tomás Sayago, Universidad Central, Colombia.

*A New Method for Decomposing Household and Firm Amenity Effects with an Application to Casino Gambling.* Michael Wenz, Northeastern Illinois University, USA.

### **Session 3.3, 4:30 – 6:00 pm, Ontario C Housing and Land I**

Chair: Geerte Cottleer, Wageningen University, The Netherlands

*A Spatial Hedonic Approach to Water Recreation Value.* Janne Artell, MTT Agrifood Research, Finland.

*The Impact of African American Migration on Housing Values in New York City Neighborhoods During the Great Depression.* Trevor Kollmann, University of Arizona, USA.

*The Benefits of Environmental Improvement: A Spatial Welfare Analysis.* John I. Carruthers, US Department of Housing and Urban Development, USA.

## Program, Thursday PM

### **Session 3.4, 4:30 – 6:00 pm, Michigan Spatial Panel Theory and Applications I**

Chair: Matthias Koch, Institut für Wirtschaftsgeographie, Austria

*Panel Data Inference Under Spatial Dependence.* Badi Baltagi, Syracuse University, USA, and Alain Pirotte, Université Panthéon-Assas Paris II, France.

*Testing Random Effects in Spatial Panel Data Models: An Alternative Approach.* Nicolas Debarsy, University of Namur, Belgium.

*Spatial Panel Econometric Analysis of the Economic Impacts of Bypasses: A Regional Approach.* Joshua B. Mills and Jon D. Fricker, Purdue University, USA.

# Program, Friday AM

## Registration

The registration desk will be open all day, starting from half an hour before the program commences. Feel free to approach the local organizers with all your questions and queries.

8:00 am – 6:00 pm      Registration

## Plenary session, 8:30 – 9:30 am, Ontario Ballroom

Chair: James P. LeSage, Texas State University-San Marcos, USA

*Cluster Estimators in Spatial Data Analysis.*

Keynote speech Timothy G. Conley, University of Chicago, Booth School of Business, USA

## Coffee Break, 9:30 – 10:00 am, Ontario Foyer

### Session 4.1, 10:00 am – 12:00 pm, Ontario A Spatial Econometric Theory III

Chair: J. Paul Elhorst, University of Groningen, The Netherlands

*Spatial Dependence in Regressors and its Effect on Estimator Performance.* R. Kelley Pace, Louisiana State University, James P. LeSage, Texas State University-San Marcos, USA, and Shuang Zhu, Louisiana State University, USA.

*The Estimation of Spatial Autoregressive Models with Missing Data of the Dependent Variables.* Matthias Koch, Institut für Wirtschaftsgeographie, Austria.

*Empirical Versus Exogenous Spatial Weighting Matrices: An Entropy-Based Intermediate Solution.* Esteban Fernández-Vázquez, University of Ociado, Spain.

# Program, Friday AM

*Spatial Econometric STAR Models: Lagrange Multiplier Tests and Monte Carlo Simulations.* Valerien O. Pede, International Rice Research Institute, Philippines, Raymond J.G.M. Florax, Purdue University, USA, Dayton Lambert, University of Tennessee, USA, and Matthew T. Holt, Purdue University, USA.

### Session 4.2, 10:00 am – 12:00 pm, Ontario B Health, Welfare and Human Development

Chair: Rafael Garduño-Rivera, University of Illinois, USA

*Poverty and Income Transfers: A Spatial Simultaneous Equation Approach.* John Musua Ulimwengu, International Food Policy Research Institute, USA, and P. Wilner Jeanty, The Ohio State University, USA.

*Medical Technology and the Production of Health Care.* Elisa Tosetti, University of Cambridge, UK, and Francesco Moscone, Brunel University, UK.

*Spatial Analysis on Neighborhood Obesity, Built Environment, and Social Capital: Los Angeles County.* Yonglin Ahn, University of Southern California, USA, and JiYoung Park, SUNY Buffalo, USA.

*Space and Race: Diverging Infant Mortality Rates in the US.* Elizabeth Dobis and Brigitte Waldorf, Purdue University, USA.

## Program, Friday AM

### **Session 4.3, 10:00 am – 12:00 pm, Ontario C Housing and Land II**

Chair: Carsten Ochsens, University of Rostock, Germany

*Selection Bias in Hedonic Pricing Models Based on Actual Sales Values.* Geerte Cottleer, Wageningen University, The Netherlands, and Raymond J.G.M. Florax, Purdue University, USA.

*Price Indices across the Distribution of Sales Prices: A Matching Approach.* Daniel P. McMillen, University of Illinois, USA.

*Estimation of Variance of Housing Prices Using Spatial Conditional Heteroskedasticity.* Pradosh Simlai, University of North Dakota, USA, and Anil K. Bera, University of Illinois, USA.

### **Lunch Break, 12:00 – 1:30 pm**

Lunch Meeting Keynote Speakers and SEA Fellows, Restaurant, by invitation only

## Program, Friday PM

### **Session 5.1, 1:30 – 3:30 pm, Ontario A Spatial Panel Theory and Applications II**

Chair: Alain Pirotte, Université Panthéon-Assas Paris II, France

*FHA's Role in a Market Without Subprime.* David T. Rodda and Leonard Carl Kiefer, Freddie Mac, USA.

*Political Risk, Business Climate and FDI in Developing and Transition Countries: Evidence from Panel Data.* Hadjila Krifa-Schneider, Université de Lille, France, and Iuliana Matei, Panthéon Sorbonne Economie, France.

*A Spatial Econometric Model of Network Coevolution.* Robert J. Franzese Jr., University of Michigan, USA, Jude C. Hays and Aya Kachi, University of Illinois, USA.

*A New Look at Growth and Convergence: Dynamic Panel with Spillover Effects.* Shaojuan Liao, Virginia Tech University, USA.

### **Session 5.2, 1:30 – 3:30 pm, Ontario B Demographics and Regional Economics**

Chair: Timo Mitze, RWI Essen and Ruhr Universität, Germany

*Is There an Age Curve?* Carsten Ochsens, University of Rostock, Germany.

*Regional Economic Analysis of Internal Migration in Mexico.* Rafael Garduño-Rivera and Kathy Baylis, University of Illinois, USA.

*A Spatial Econometric Analysis of Global Natural Disasters.* Zahra Golshani, University of Illinois, USA, and Ali Asgary, York University, Canada.

## Program, Friday PM

### **Session 5.3, 1:30 – 3:30 pm, Ontario C** **Spatial Testing and Software Tools**

Chair: Xiaokun (Cara) Wang, Bucknell University, USA

*Symbolic Dynamics to Test Basic Hypotheses in Econometric Models.* Fernando López, Technical University of Cartagena, Spain, Mariano Matilla-García, UNED, Spain, and Jesus Mur, University of Zaragoza, Spain, and Manuel Ruiz Marín, Technical University of Cartagena, Spain.

*A Practical Proposal to Specification Search with the Spatial J-Test.* Linda Gerkman, Hanken School of Economics, Finland.

*Open-Source Spatial Analysis Tools: Impact on Professional Practice in Government, Business and Non-profit Organizations.* Fernando DePaolis, Monterey Institute of International Studies, USA.

### **Session 5.4, 1:30 – 3:30 pm, Michigan** **Space, Pricing and Competition**

Chair: John I. Carruthers, US Department of Housing and Urban Development, USA

*Pricing with Asymmetric Competition: Evidence from the Retail Gasoline Market.* Matthias Firgo, Wirtschaftsuniversität Wien, Austria, Dieter Pennerstorfer, Austrian Institute of Economic Research, Austria, and Christoph Weiss, Wirtschaftsuniversität Wien, Austria.

*Dominant Firms and the Competitive Fringe: A Spatial Price Analysis.* C. Gustav Helmers, Raymond J.G.M. Florax, Purdue University, USA, and Govert Vroom, University of Navarra, Spain.

*Forced Displacement in Colombia, Two Interacting Dynamics.* Juan Tomás Sayago, Universidad Central, Colombia.

### **Coffee Break, 3:30 – 4:00 pm, Ontario Foyer**

## Program, Friday PM

### **Session 6.1, 4:00 – 6:00 pm, Ontario A** **Spatial Econometric Theory IV**

Chair: Robert J. Franzese, Jr., University of Michigan, USA

*Testing for Causality in Spatial Models: Nonparametric vs. Parametric Approaches.* Marcos Herrera, Jesus Mur, University of Zaragoza, Spain, Jean Paelinck, George Mason University, USA, and Manuel Ruiz Marín, Technical University of Cartagena, Spain.

*Specification and Estimation of the Dynamic Spatial Multinomial Probit Model.* Xiaokun (Cara) Wang, Bucknell University, USA, Kara M. Kockelman, University of Texas, USA, and Jason D. Lemp, Cambridge Systematics, USA.

*Industry Value Chains and Economic Growth in the Appalachian Region, 2000 to 2007: An Exploration with Smooth Transition Autoregressive Models.* Dayton M. Lambert, Wan Xu, University of Tennessee, USA, and Raymond J.G.M. Florax, Purdue University, USA.

### **Session 6.2, 4:00 – 6:00 pm, Ontario B** **Urban Analysis II**

Chair: Elisa Tosetti, Cambridge University, UK

*Institutions, Spillovers and Growth in a Cross Section of Cities: The Case of European Metropolises, 1990 to 2005.* Catherine Baumont and Rachel Guillain, Université de Bourgogne, France.

*Processes of Economic Openness, Growth and Urban Concentration: Are Developing Countries Different?* Fernando DePaolis, Monterey Institute of International Studies, USA.

*A Spatial Multinomial Analysis of Land-Use Conversion at the Rural-Urban Fringe.* Carmen E. Carrión-Flores, Alfonso Flores-Lagunes and Ledia Guci, University of Florida, USA

*Farmland Allocation Along the Rural-Urban Gradient: The Impact of Urban Growth or Sprawl.* Benoît A. Delbecq and Raymond J.G.M. Florax, Purdue University, USA.

## Program, Friday PM

### **Session 6.3, 4:00 – 6:00 pm, Ontario C Economic Growth II**

Chair: Juan Tomás Sayago, Universidad Central, Colombia

*Global Cointegration in the Analysis of the German Regional Growth-Trade-FDI Nexus.* Timo Mitze, RWI Essen and Ruhr Universität, Germany.

*An Application of the Disequilibrium Adjustment Framework to Small Area Forecasting and Impact Analysis.* Jae Hong Kim and Geoffrey J.D. Hewings, University of Illinois, USA.

*A Framework for Comparative Space-Time Analysis.* Xinyue Ye, Bowling Green State University, USA.

### **Session 6.4, 4:00 – 6:00 pm, Michigan Knowledge Diffusion and Spillovers**

Chair: Stefano Magrini, Ca'Foscari University of Venice, Italy

*The Spatial Distribution of Human Capital: Can it Be Explained by Regional Differences in Market Access?* Burhan Can Karahasan and Enrique López-Bazo, University of Barcelona, Spain.

*Did Welfare Reform in the US Induce a Race to the Bottom in Cash Assistance to the Poor? Evidence Using States' Welfare Expenditures from 1997 to 2006.* Luz A. Saavedra, University of St. Thomas, USA.

*Locally Linear Spatial Estimation of Ethanol Demand in Minnesota.* Hayk Khachatryan, Eric Jessup, and Kenneth Casavant, Washington State University, USA.

## Program, Friday PM

### **Business Meeting, 6:00 – 7:00 pm**

Meeting of the Board of Founding Fellows, St. Clair Boardroom, by invitation only

### **Conference Dinner, 7:00 – 9:00 pm**

Includes award presentation of the first and second prizes of the graduate student paper competition

# Program, Saturday AM

## Registration

The registration desk will be open all day, starting from half an hour before the program commences. Feel free to approach the local organizers with all your questions and queries.

8:00 am – 12:00 pm      Registration

## Plenary session, 8:30 – 9:30 am, Ontario Ballroom

Chair: Daniel P. McMillen, University of Illinois, USA

*Teaching Spatial Econometrics: A Panel Discussion*

Panelists:

Giuseppe Arbia, University of Pescara, Italy,  
Fernando DePaolis, Monterey Institute of International Studies, USA,  
Donald J. Lacombe, West Virginia University, USA,  
Nicolas Debarsy, University of Namur, Belgium.

## Coffee Break, 9:30 – 10:00 am, Ontario Foyer

## Plenary session, 10:00 am – 12:00 pm, Ontario Ballroom

Chair: Raymond J.G.M. Florax, Purdue University, USA

*Spatial Analysis Software: Demonstrations*

Packages and demonstrators:

*MATLAB, Spatial Econometrics Toolbox.* James P. LeSage, Texas State University at San Marcos, USA, and J. Paul Elhorst, University of Groningen, The Netherlands.

*STATA.* David Drukker, Director of Econometrics Stata Corp., USA.

*R, spdep, sphet and splm.* Roger Bivand, Norwegian School of Economics and Business Administration, Norway.

# Index to Participants

The index refers to the following abbreviations:

PS      Plenary Session  
T      Teaching Spatial Econometrics Panel  
SW      Software Demonstrations  
LOC      Local Organizing Committee  
BoD      Board of Directors  
SAB      Scientific Advisory Board  
GSC      Jury Graduate Student Paper Competition  
FEL      Fellow Spatial Econometrics Association

Ahn, Y. 4.2  
Allers, M. 3.1  
Angulo, A. 1.1  
Anselin, L. SAB, BoD, FEL  
Arbia, G. SAB, GSC, BoD, FEL,  
PS, 1.2, 2.1, T  
Artell, J. 3.3  
Asgary, A. 5.2  
Baltagi, B. SAB, BoD, FEL, 3.4  
Bao, Y. LOC, 1.1, 2.1  
Baumont, C. 6.2  
Baylis, K. 5.2  
Belitski, M. 2.2  
Ben Arfa, N. 3.2  
Bera, A. SAB, GSC, FEL, PS,  
1.4, 2.1, 4.3  
Bester, C. 1.1  
Bivand, R. SAB, SW  
Bode, E. GSC  
Carrión-Flores, C. 6.2  
Carruthers, J. 3.3, 5.4  
Casavant, K. 6.4  
Conley, T. GSC, 1.1, PS  
Cotteleer, G. 3.3, 4.4  
Cressie, N. FEL  
Daniel, K. 3.2  
Das Gupta, D. 1.1  
Dauth, W. 1.2, 2.3  
Debarsy, N. 1.4, 3.4, T  
Delbecq, B. LOC, 6.2  
DePaolis, F. 1.3, 5.3, 6.2, T  
Dobis, E. LOC, 4.2  
Elhorst, P. 3.1, 4.1, SW  
Enriquez, H. 3.2  
Espa, G. 1.2  
Fernández-Vázquez, E. 4.1  
Fingleton, B. SAB, FEL  
Firgo, M. 1.2, 5.4  
Florax, R. LOC, SAB, FEL, PS,  
1.3, 2.4, 4.1, 4.3, 5.4, 6.1, 6.2,  
SW  
Flores-Lagunes, A. SAB, 1.3,  
6.2  
Franzese, R. 5.1, 6.1  
Fricker, J. 3.4  
Garduno-Rivera, R. 4.2, 5.2  
Gerkman, L. 5.3  
Gerolimetto, M. 2.3  
Giuliani, D. 1.2  
Golshani, Z. 5.2  
Gori-Maia, A. 2.4  
Griffith, D. FEL  
Guci, L. 6.2  
Guillain, R. 6.2  
Haining, R. FEL  
Hansen, C. 1.1

## Index, continued

Hays, J. 5.1  
Helmets, G. LOC, 5.4  
Hernández-Murillo, R. 1.4  
Herrera, M. 6.1  
Hewings, G. 6.3  
Holloway, G. 3.1  
Holt, M. 4.1  
Irwin, E. SAB  
Jacquet, F. 3.2  
Jeanty, P. 4.2  
Jessup, E. 6.4  
Kachi, A. 5.1  
Karahasan, B. 6.4  
Kelejian, H. BoD, FEL  
Kelekar, U. 1.1  
Khachatryan, H. 6.4  
Kiefer, L. 5.1  
Kim, J. 6.3  
Klarl, T. 1.2, 3.2  
Koch, M. 3.4, 4.1  
Kockelman, K. 6.1  
Kollmann, T. 3.3, 6.2  
Koppelman, F. 2.2  
Krifa-Schneider, H. 5.1  
Lacombe, D. 3.1, T  
Lambert, D. SAB, 4.1, 6.1  
Lee, L.-F. FEL  
Lemp, J. 6.1  
Le Gallo, J. SAB  
LeSage, J. SAB, FEL, 3.1, PS,  
4.1, SW  
Liao, S. 5.1  
López, F. 1.1, 5.3  
López-Bazo, E. SAB, 6.4  
Lu, C. 2.1, 3.1  
Magrini, S. 2.3, 6.4  
Matei, I. 5.1  
Matilla-Garcia, M. 5.3  
McMillen, D. SAB, 2.2, 2.4,  
4.3, T  
Mills, J. 3.4  
Mitze, T. 5.2, 6.3  
Mohammadian, A. 2.2  
Moscone, F. 2.2, 4.2  
Mur, J. GSC, FEL, 1.1, 5.3, 6.1  
Murakami, D. 1.4  
Ochsen, C. 4.3, 5.2  
Odhiambo, N. 2.3  
Pace, K. 4.1  
Paelinck, J. BoD, FEL, 1.1, 6.1  
Parent, O. 2.1, 3.1  
Park, J. 4.2  
Pede, V. 4.1  
Pellegrini, G. GSC  
Pennerstorfer, D. 5.4  
Pesaran, H. F  
Pfaffermayr, M. SC  
Piras, G. 2.1  
Pirrotte, A. 3.4, 5.1  
Prucha, I. SAB, BoD, FEL  
Quah, D. F  
Rashidi, T. 2.2  
Rey, S. F  
Robinson, P. BoD, FEL  
Rodda, D. 5.1  
Ruiz Marín, M. 5.3, 6.1  
Saavedra, L. 6.4  
Sage, J. 2.2  
Sanyal, P. 2.3  
Sayago, J. 3.2, 5.4, 6.3  
Schanne, N. 2.4  
Sen, M. 1.4  
Sengupta, R. 1.4  
Seya, H. 3.1  
Shaughnessy, T. 3.1  
Shepotylo, O. 1.3

## Index, continued

Simlai, P. 4.3  
Snyder, S. 2.4  
Tjostheim, D. FEL  
Tosetti, E. 2.2, 2.4, 4.2  
Tsutsumi, M. 1.4, 3.1  
Ulimwengu, J. 2.3, 4.2  
Vogelsang, T. 1.1  
Vroom, G. 5.4  
Waldorf, B. LOC, 4.2  
Wang, X. 5.3, 6.1  
Ward, P. LOC, 1.3  
Weiss, C. 5.4  
Wenz, M. 3.2  
Xu, W. 6.1  
Yang, Z. 2.1  
Ye, X. 6.3  
Zhu, S. 4.1